

+ Types of sliding automatic doors



2-piece



3-piece



Double sliding



Break-out



handicapped toilet



Telescopic



Clean Room



Smooth Door

+ Operator Box Production bending

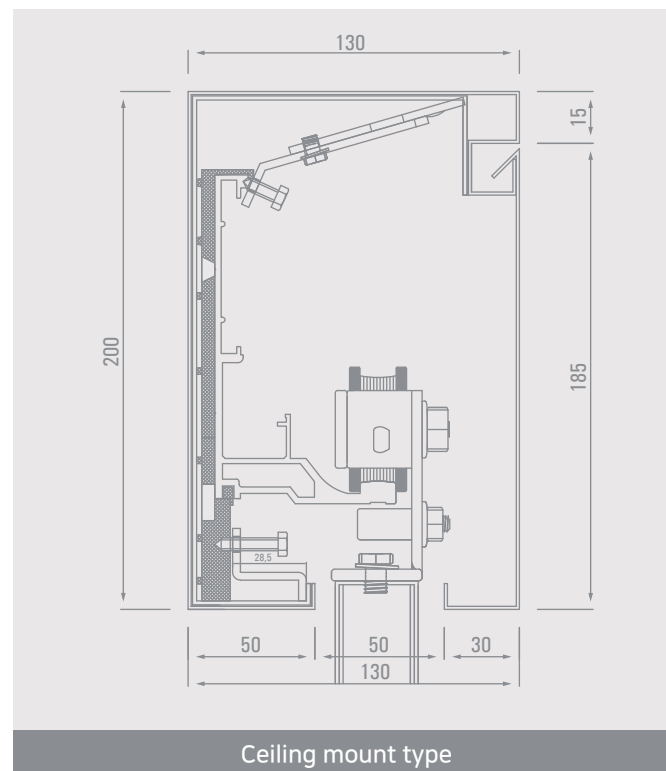
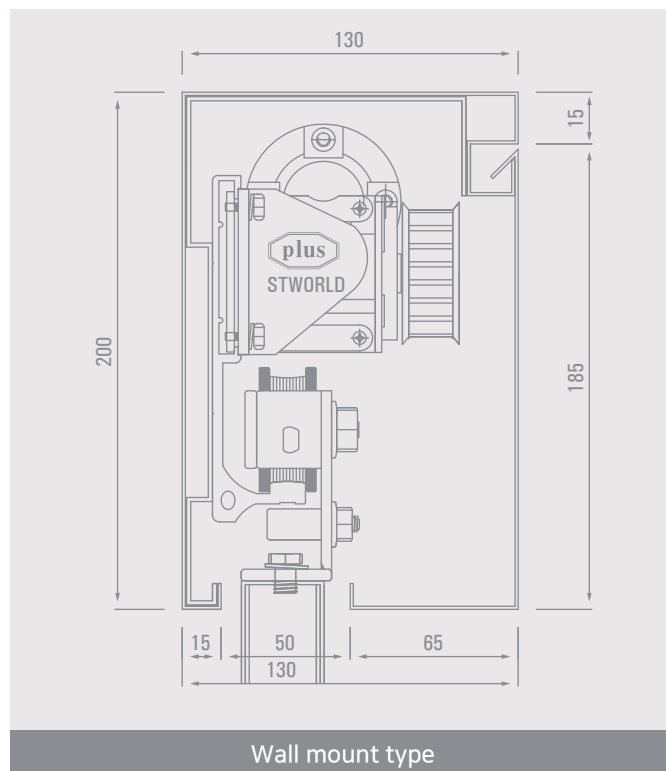

AUTO DOORS



Automatic Door Operator ST-N Series

(ST-N10, ST-N15, ST-N20, ST-N25, ST-N50)



+ Product Component

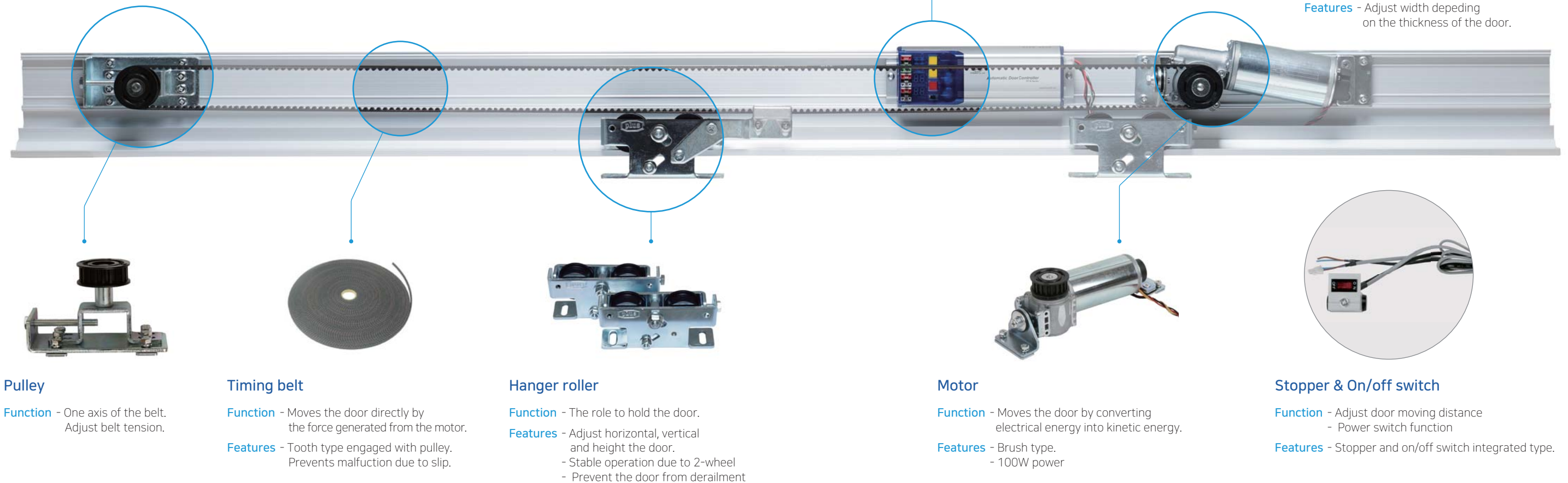

+ Product Features

Convenience	<ul style="list-style-type: none">- Easy to install and reduces installation time- Easy to connect the upper sensor, safety sensor, etc. by using press type.- 2 FNDs and 5 LEDs make it easy to check the status of automatic door and to operate.	Efficiency	<ul style="list-style-type: none">- Using high performance DC motor, high speed and continuous operation are possible.- Remember the opening distance. (Avoid unnecessary test run when power on)
Safety	<ul style="list-style-type: none">- In the event of a collision with something, the door reopens for safety- On 4 consecutive collisions at the same point, the door doesn't close for 1 minute.- Side screen safety function.- Adjust opening and closing speed- 2-wheel hanger roller ensures stable operation even on heavy doors.	Functionality	<ul style="list-style-type: none">- By adopting 32-bit MICOM based on ARM-Core, it is possible to implement various functions and precise control of minute details.- Push and Go function can be used without sensors depending on site conditions.- One-way, two-way and one-touch function can be used.- Counting function (opening number, collision number, power-on number)- Can check traffic volume
Reliability	<ul style="list-style-type: none">- Various certificates. (ISO9001, CE, 3 million cycling test, etc.)- A dedicated IC was used for the device for driving the motor to lower the heat generation temperature it.		

+ Product Specifications

Model	ST-N Series	
Door weight	Max. 180kg x 1	Max. 160kg x 2
Moving distance	500 ~ 3,000mm	1,000 ~ 6,000mm
Power supply	AC220V (176~242V), SMPS type, AC Current: 0.7A, Frequency: 50/60 Hz, Peak power: 150W	
Control	PI (Proportional Integrate) Control	
Motor	100W, DC Motor (DC-24V), Germany	
Opening speed	135mm/sec ~ 550mm/sec	
Closing speed	75mm/sec ~ 350mm/sec	
Opened hold time	Max. 99 seconds.	
Push and Go	Possible	